

HP10000 Hoist Plug

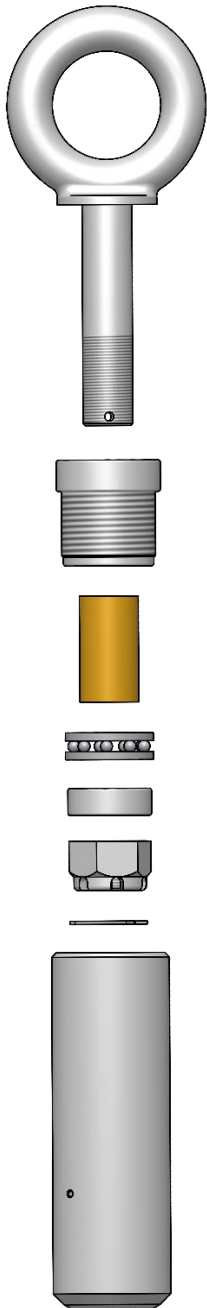

DESCRIPTION

The HP10000 is a box-thread heavy-bodied coupling with a swivel-mounted eye. When attached to the hook on the drill-hoist line, the NW Rod Box threaded end can be easily subbed to match your drill string, and screwed onto the rods to hoist and otherwise handle drill-string equipment when making borehole round trips.

The body is manufactured from solid steel and the unit uses a custom heavy duty thrust bearing to provide ease of connection while reducing hoisting cable winding during hoisting and lowering.

FEATURES

- Load tested to 10,000#
- 6 welded grip lines for easier installation
- Robust Steel Body
- Forged Steel Shoulder Rivet Eyebolt
- Heavy Duty 1-3/8" Thrust Bearing
- Tool Length: 16-1/2" OAL
- Tool Weight: 25#
- Tool Connection: NW Rod Box